

***** PUBLIC NOTICE *****

UNIVERSITY OF ALASKA

**UNIVERSITY OF ALASKA
OVER-THE-COUNTER COMMERCIAL BUILDING SALE**

**BILL RAY CENTER OFFICE BUILDING
AND PARKING LOT
DISPOSAL PLAN**

LOCATION:

1108 F t, S 1kh.R57d[u3.kn3.k(t, au3.k(, AaskI)-#a 9801)

UNIVERSITY OF ALASKA

Bill Ray Center

JU.BR.4XXX

R 67E

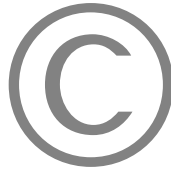

W. Twelfth Street

Glacier Avenue

F STREET

Parking Lot

Egan Drive

W. Tenth Street

T 41S

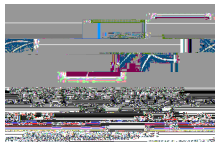

100
Feet

**UA FACILITIES and
LAND MANAGEMENT
March 2013**

Meridian Township Range
CR 41S 67E

Juneau B-2 (USGS)

Bill Ray Center

JU.BR.4XXX

Egan Drive

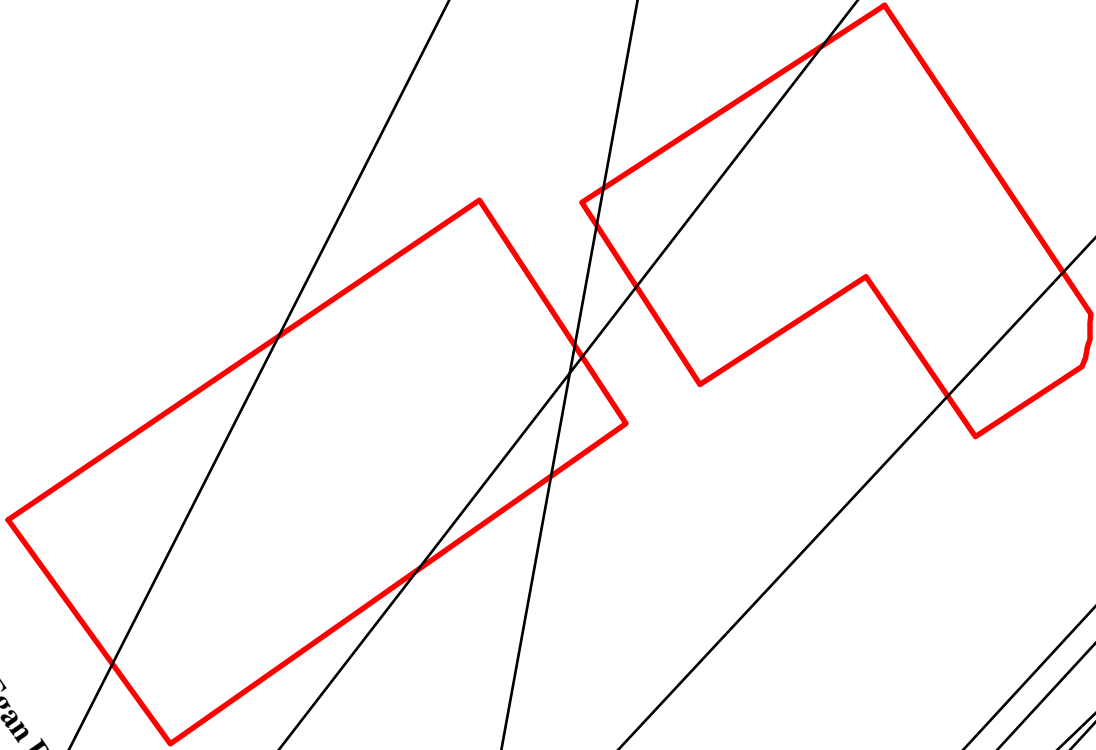

**UA FACILITIES and
LAND MANAGEMENT**
March 2013

Meridian Township Range
CR 41S 67E

100

Feet

Juneau B-2 (USGS)